

FREEHOLD



House - Semi-Detached

# HALE CLOSE, EDGWARE

Offers In The Region

# £700,000

## FEATURES

- Development potential family house
- 3 bedroom semi-detached with space to extend
- Large rear garden
- Long driveway at side of house
- Garage/outhouse
- Front garden
- Quite location
- Chain free



**SPACE**  
RESIDENTIAL

# 3 Bedroom House - Semi-Detached located in Edgware

Space Residential are delighted to present this fabulous 3-bedroom semi-detached house offering huge development potential at the side, rear and into the loft space (subject to obtaining planning consent).

Offered for sale chain-free and located in a quiet cul-de-sac of only 6 houses, this family home allows any would-be buyer a template to build their own dream home or a developer with vision and imagination a wonderful opportunity.

The house comprises 2 reception rooms on the ground floor and a kitchen. On the first floor are 2 double and 1 single bedrooms along with a family bathroom and separate W.C.

Externally, the house presents a front garden, a large rear garden with a side access and an outhouse and a driveway running down the side of the house.

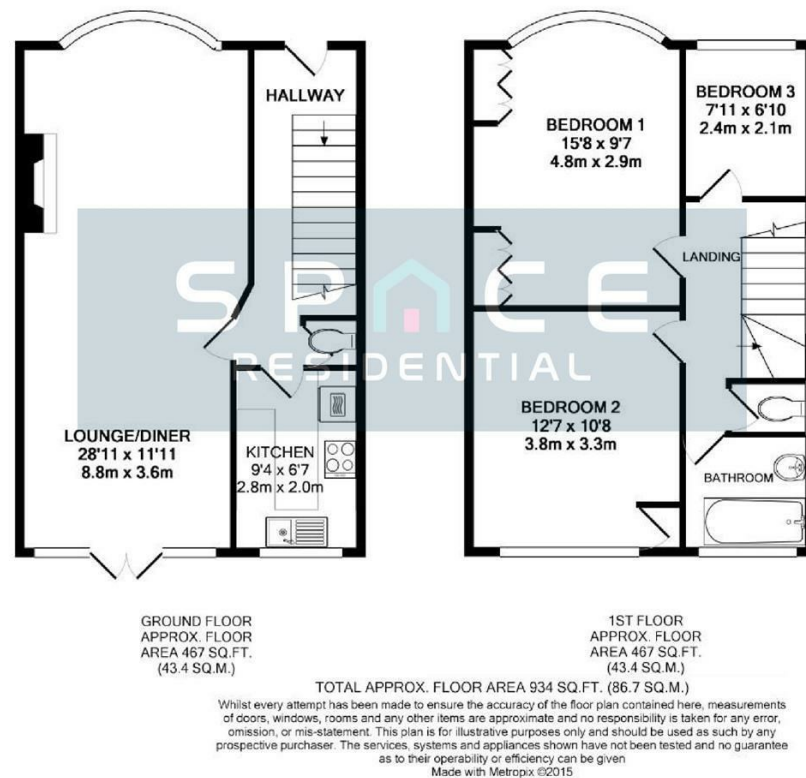

Call us on

**0208 906 2222**

[info@spaceresidential.com](mailto:info@spaceresidential.com)  
[spaceresidential.com](http://spaceresidential.com)

**Council Tax Band**

**E**

Energy Efficiency Rating		
	Current	Potential
Very energy efficient - lower running costs		
(92 plus) <b>A</b>		<b>86</b>
(81-91) <b>B</b>		
(69-80) <b>C</b>		
(55-68) <b>D</b>		
(39-54) <b>E</b>		
(21-38) <b>F</b>	<b>25</b>	
(1-20) <b>G</b>		
Not energy efficient - higher running costs		
England & Wales		EU Directive 2002/91/EC

Agents Note: Whilst every care has been taken to prepare these particulars, they are for guidance purposes only. All measurements are approximate and are for general guidance purposes only and whilst every care has been taken to ensure their accuracy, they should not be relied upon and potential buyers are advised to recheck the measurements.

**SPACE**  
RESIDENTIAL